

AS Heavy Duty (ASHD) Series Connectors



Autosport design for high current motorsport applications

- Early break / Late mate on data contacts for safety
- Cable accommodation from 16mm² - 70mm²
- Positive locking coupling mechanism



High performance materials

- Environmentally sealed
- Thermal cycle tested
- Heavy duty rated
- Crimp type solid and gold plated copper contacts



For Parts Dimensions, Refer to pages 24 to 27

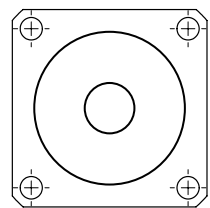

SuperASHD Single
70mm² contact

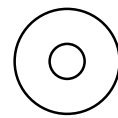

ASHD14-1
(1 x AWG 4)

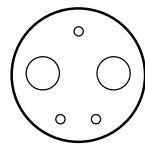

AS 22-24320
(2 x AWG 4, 3 x AWG 20)

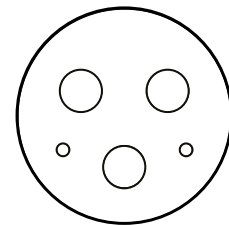

AS 24-34220
(3 x AWG 4, 2 x AWG 20)

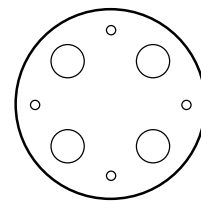

AS 24-44420
(4 x AWG 4, 4 x AWG 20)

All dimensions are in mm unless otherwise stated.

CONTACTS & TOOLING PART NUMBERS

Contact Size	Socket	Pin	Filler Plug	Ins/Ext Tool	Crimp Tool	Socket Positioner	Pin Positioner
20	38943-20	38941-20	600300-20	M81969/14-10	M22520/2-01	M22520/2-10	M22520/2-10

Please note: PCB versions are ordered with AS2 prefixes and come with contacts.

Wire Size	Split-Finger Socket	Hyperboloid Socket	Pin	Ext Tool	Crimp Tool	Jaws	Contact	Max. Current
16mm	611103-016	605739	605734	610136-Tool	605773	605774	20	7.5
25mm	611103-025	605654	605660			605775	4	200
35mm	611103-035	605740	605735			605776	0**	300

*For use with part numbers ASHD022-24320SN-S04 and ASHD622-24320PN-004

** Super ASHD only

Application Note: Due to potential high current, we would recommend that the product be suitably insulated with the appropriate materials.

ORDERING INFORMATION

ASHD * * - * * * - *** - ****

Range Ref.: _____

Style:
 0
 1
 2 (ASHD size 14 only)
 6

Shell Size:
 14 = ASHD
 22 = ASHD 2-Way and SuperASHD
 24 = ASHD 3 and 4-Way

Contact Arrangement:
 1 = (ASHD)
 24320 = (size 22)
 34220 = (size 24) 3-Way
 44420 = (size 24) 4-Way
 1 = (Super ASHD)

Insert Type:
 P = Pin
 S = Socket

Shell Keyways:
 N = Red (standard)
 A = Yellow
 B = Blue
 C = Orange
 D = Green
 E = Grey

Harsh Environment:
 Contact Size Code
 *16
 *25
 *35

Modification Code: _____

*With Pin contacts, C for size 14 shell only / O for other sizes. With Socket contacts, C for hyperboloid contacts for size 14 shell only / O for hyperloid contacts for other sizes / S for split finger contacts.