

Copper, Heavy Duty Lugs, 8 Gauge to 4/0 AWG



Features and Benefits

- Flared Barrel Entry: Ease of Wire Insertion
- Annealed Copper Barrel: Strong Pullout Resistance
- Work-hardened Tang: Tear Resistant
- Round Transition: Fatigue Resistance
- Concentric Barrel: Ease of Wire Insertion
- Oxygen Inhibitor: Corrosion/Tarnish Resistance
- Tin Plating: Corrosion Resistance
- UL/CUL Listed: Operating Safety and Effectiveness
- Complete Range of Studholes: Fits Any Size

Heavy Duty Copper Lugs

Description: ASK Power's Heavy Duty Terminal Lugs, available with crimp or solder connections and bolted terminations, incorporate rounded tangs, flared barrel entry, and moderate-sloping transitions. These lugs are bare copper and can be tinned or bent. Formed from high-purity annealed copper with heavy duty walls, they provide excellent ductility, conductivity, security, and tang strength. ASK non-insulated lugs accommodate wire sizes 8 Gauge through 4/0 AWG. Crimp barrels are sized to closely match commercial battery and power-cable strand diameters. Wire gauge and UL mark appears clearly on wire barrel.

Recommended Uses: ASK's larger-gauge cable lugs are used for power transmission and/or grounding in utility and transformer applications. Rounded tangs allow for rotation of terminals around stud connections through 360 degree rotation, where cables must enter at any angle specified. Flared barrels allow for more highly-stranded battery cable to be submitted into funnel-entry crimp barrels for ease of insertion. The 8 gauge to 1 gauge size range covers amperage from 40 Amps to 115 Amp service at 600 Volts per UL 486A. Pull test values range from 90 to 200 pounds at 8Ga and 1Ga respectively. Circular Mills, or the area in millimeters as defined by the stranding diameter, range from 11 to 32 for the 8Ga to 1Ga range. The 1/0 to 4/0 AWG size range covers an amperage from 125 Amps to 225 Amps service at 600 volts per UL 486 A. Pull test values range from 200 to 350 pounds at 1/0 to 4/0 AWG respectively. Circular Mills range from 40 to 75 for the 1/0 to 4/0 AWG range.

Tooling and Application: Crimp lugs can be applied to cable via hand-actuated or hydraulic crimp tools. Our Heavy Duty Copper Lugs are UL Listed (UL 486 A) when using the Thomas and Betts M5 tool or the Burndy tool. These same lugs can be connected by solder-dipping. Single crimp is used for standard barrel lugs; double crimp for long or extended barrel lugs.

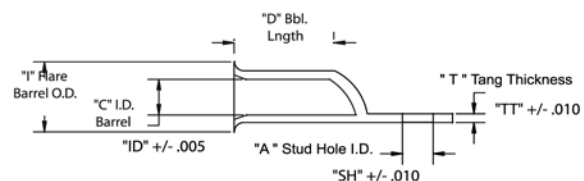
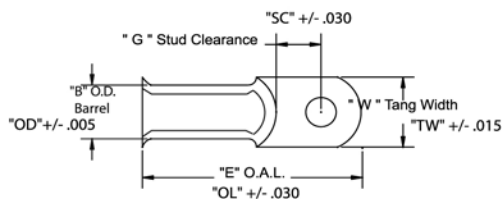

Copper, Heavy Duty Lugs, 8 Gauge to 4/0 AWG

Heavy Duty Lug, Flared Barrel, Round Tang, Bare or Tinned Copper, 8Gauge-4/0 AWG

ASK Part No	Barrel Config	AWG Gauge	Nominal Stud Size	Barrel Config	Finish	Barrel Flare "I"	Barrel I.D. "C"	Barrel Lng "D"	Overall Length "E" Tol	Tang Length "F"	Tang Width "E"	#Crimps
Tolerance						+0.010/-0.010	+0.010/-0.010	+/-0.030	+/-0.060	+/-0.060	+/-0.030	
8-8	Flare	8	#8	Flared	Bare CU or Tinned	0.285	0.186	0.270	1.130	0.640	0.465	1
810	Flare	8	#10	Flared	Bare CU or Tinned	0.285	0.186	0.270	1.130	0.640	0.465	1
814	Flare	8	1/4	Flared	Bare CU or Tinned	0.285	0.186	0.270	1.130	0.640	0.465	1
8142	Flare	8	1/4	Flared	Bare CU or Tinned	0.235	0.180	0.400	1.190	0.550	0.437	1
8516	Flare	8	5/16	Flared	Bare CU or Tinned	0.285	0.186	0.270	1.130	0.640	0.465	1
838	Flare	8	3/8	Flared	Bare CU or Tinned	0.285	0.186	0.270	1.130	0.640	0.570	1
812	Flare	8	1/2	Flared	Bare CU or Tinned	0.285	0.186	0.270	1.260	0.710	0.640	1
6-8	Flare	6	#8	Flared	Bare CU or Tinned	0.342	0.232	0.425	1.320	0.700	0.465	1
610	Flare	6	#10	Flared	Bare CU or Tinned	0.342	0.232	0.425	1.320	0.700	0.465	1
6102	Flare	6	#10	Flared	Bare CU or Tinned	0.235	0.232	0.425	1.320	0.550	0.437	1
614	Flare	6	1/4	Flared	Bare CU or Tinned	0.342	0.232	0.425	1.320	0.640	0.540	1
6142	Flare	6	1/4	Flared	Bare CU or Tinned	0.235	0.232	0.425	1.320	0.550	0.437	1
6516	Flare	6	5/16	Flared	Bare CU or Tinned	0.342	0.232	0.425	1.320	0.640	0.540	1
638	Flare	6	3/8	Flared	Bare CU or Tinned	0.342	0.232	0.425	1.320	0.640	0.540	1
612	Flare	6	1/2	Flared	Bare CU or Tinned	0.342	0.232	0.425	1.320	0.640	0.670	1
410	Flare	4	#10	Flared	Bare CU or Tinned	0.410	0.286	0.450	1.370	0.660	0.545	1
414	Flare	4	1/4	Flared	Bare CU or Tinned	0.410	0.286	0.450	1.370	0.660	0.545	1
4516	Flare	4	5/16	Flared	Bare CU or Tinned	0.410	0.286	0.450	1.370	0.660	0.545	1
438	Flare	4	3/8	Flared	Bare CU or Tinned	0.410	0.286	0.450	1.370	0.660	0.570	1
412	Flare	4	1/2	Flared	Bare CU or Tinned	0.410	0.286	0.450	1.370	0.660	0.670	1
214	Flare	2	1/4	Flared	Bare CU or Tinned	0.472	0.336	0.500	1.610	0.690	0.650	1
2516	Flare	2	5/16	Flared	Bare CU or Tinned	0.472	0.336	0.500	1.610	0.690	0.650	1
238	Flare	2	3/8	Flared	Bare CU or Tinned	0.472	0.336	0.500	1.610	0.690	0.650	1
212	Flare	2	1/2	Flared	Bare CU or Tinned	0.472	0.336	0.500	1.610	0.690	0.750	1
25162	Flare	2 wide pad	5/16	Flared	Bare CU or Tinned	0.472	0.336	0.500	1.590	0.690	0.620	1
2382	Flare	2 wide pad	3/8	Flared	Bare CU or Tinned	0.472	0.336	0.500	1.590	0.690	0.620	1
114	Flare	1	1/4	Flared	Bare CU or Tinned	0.495	0.360	0.500	1.550	0.690	0.645	1
1516	Flare	1	5/16	Flared	Bare CU or Tinned	0.495	0.360	0.500	1.550	0.690	0.645	1
138	Flare	1	3/8	Flared	Bare CU or Tinned	0.495	0.360	0.500	1.550	0.690	0.675	1
112	Flare	1	1/2	Flared	Bare CU or Tinned	0.495	0.360	0.500	1.550	0.690	0.750	1
1014	Flare	1/0	1/4	Flared	Bare CU or Tinned	0.535	0.410	0.625	1.840	0.760	0.745	1
10516	Flare	1/0	5/16	Flared	Bare CU or Tinned	0.535	0.410	0.625	1.840	0.760	0.745	1
1038	Flare	1/0	3/8	Flared	Bare CU or Tinned	0.535	0.410	0.625	1.840	0.820	0.745	1
1012	Flare	1/0	1/2	Flared	Bare CU or Tinned	0.535	0.410	0.625	1.840	0.820	0.745	1
2014	Flare	2/0	1/4	Flared	Bare CU or Tinned	0.595	0.460	0.650	2.045	0.900	0.825	1
20516	Flare	2/0	5/16	Flared	Bare CU or Tinned	0.595	0.460	0.650	2.045	0.900	0.825	1
2038	Flare	2/0	3/8	Flared	Bare CU or Tinned	0.595	0.460	0.650	2.045	0.900	0.825	1
20382	Flare	2/0 wide	3/8	Flared	Bare CU or Tinned	0.595	0.460	0.650	2.020	0.900	0.810	1
2012	Flare	2/0	1/2	Flared	Bare CU or Tinned	0.595	0.460	0.650	2.045	0.900	0.825	1
3014	Flare	3/0	1/4	Flared	Bare CU or Tinned	0.655	0.510	0.675	2.240	0.990	0.910	1
30516	Flare	3/0	5/16	Flared	Bare CU or Tinned	0.655	0.510	0.675	2.240	0.990	0.910	1
3038	Flare	3/0	3/8	Flared	Bare CU or Tinned	0.655	0.510	0.675	2.240	0.990	0.910	1
3012	Flare	3/0	1/2	Flared	Bare CU or Tinned	0.655	0.510	0.675	2.240	0.990	0.910	1
4014	Flare	4/0	1/4	Flared	Bare CU or Tinned	0.713	0.559	0.700	2.290	1.015	1.000	1
40516	Flare	4/0	5/16	Flared	Bare CU or Tinned	0.713	0.559	0.700	2.290	1.015	1.000	1
4038	Flare	4/0	3/8	Flared	Bare CU or Tinned	0.713	0.559	0.700	2.290	1.015	1.000	1
4012	Flare	4/0	1/2	Flared	Bare CU or Tinned	0.713	0.559	0.700	2.290	1.015	1.000	1
4058	Flare	4/0	5/8	Flared	Bare CU or Tinned	0.713	0.559	0.700	2.290	1.015	1.000	1

Product Options

- Part Numbers listed are Bare Copper. For Tinned Lug, add "TP" to end of part number.
- For Bent Tang Lugs, add "45" or "90" to end of part number (after TP, if tinned).
- For special tang widths, stud clearances, barrel lengths, or any option you don't see, contact the Plant.