

Copper, Long Heavy Duty Lugs

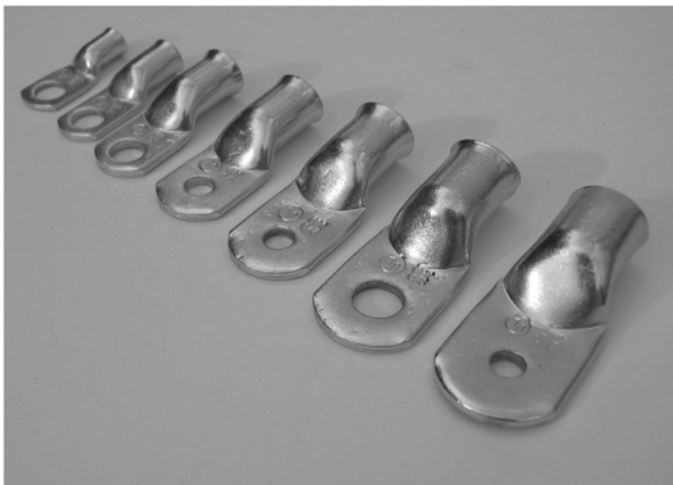

Heavy Duty Extended Copper Lugs

Description: ASK Power's Heavy Duty Extended Terminal Lugs, available with crimp or solder connections and bolted terminations, incorporate extended crimp barrel for double crimp and enhanced pull-out values and conductivity. The lugs also incorporate rounded tangs, flared barrel entry, and moderate-sloping transitions. These lugs are bare copper and can be tinned or bent. Formed from high-purity annealed copper with heavy duty walls, they provide excellent ductility, conductivity, security, and tang strength. ASK non-insulated lugs accommodate wire sizes 4 Gauge through 1 Gauge. Crimp barrels are sized to closely match commercial battery and power-cable strand diameters. Wire gauge and UL mark appears clearly on wire barrel.

Recommended Uses: ASK's larger-gauge cable lugs are used for power transmission and/or grounding in transformer applications. Where high vibration environments can work cable free in short wall, single crimp lugs, these extended barrel lugs are especially useful in improving performance. Rounded tangs allow for rotation of terminals around stud connections through 360 degree rotation, where cables must enter at any angle specified. Flared barrels allow for more highly-stranded battery cable to be submitted into funnel-entry crimp barrels for ease of insertion. This size range covers amperage from 85 Amps to 115 Amp service at 600 Volts per UL 486A. Pull test values range from 140 to 200 pounds at 4Ga and 1Ga respectively.

Tooling and Application: Crimp lugs can be applied to cable via hand-actuated or hydraulic crimp tools. Our Heavy Duty Copper Lugs are UL Listed (UL 486 A) utilizing the Thomas and Betts M5 tool or the Burndy air over hydraulic tools. These same lugs can be connected by solder-dipping. Double crimp for long or extended barrel lugs.

Features and Benefits

- Flared Barrel Entry for Ease of Wire Insertion
- Extended Barrel Allows Multiple Crimps for Enhanced Pullout Resistance and Extended Conductivity Life
- Annealed Copper Barrel for Strong Pullout Resistance
- Work-Hardened Tang for Tear Resistance
- Round Transition for Fatigue Resistance
- Concentric Barrel for Ease of Wire Insertion
- Oxygen Inhibitor for Corrosion/Tarnish Resistance
- Tin Plating: Corrosion Resistance
- UL/CUL Listing guarantees Operating Safety and Effectiveness
- Complete Range of Studholes

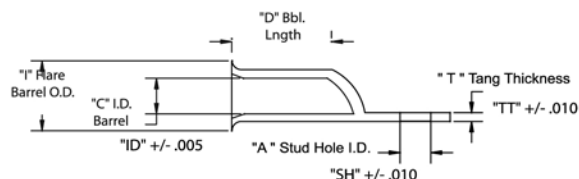
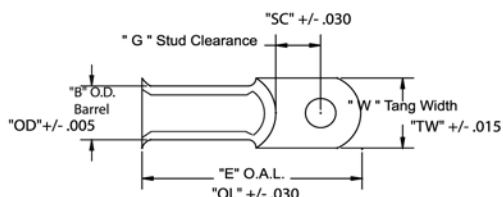

Don't see what you're looking for? Call us at 866.457.4830 for assistance.

Copper, Long Heavy Duty Lugs

Heavy Duty Lug, Extended, Flared Barrel, Round Tang, Bare or Tinned Copper, 4Gauge-1Gauge

ASK Part No	Barrel Config	AWG Gauge	Nominal Stud Size	Chamfer	Finish	Barrel Flare "I"	Barrel I.D. "C"	Barrel Lng "D"	Overall Length "E" Tol	Tang Length "F"	Tang Width "W"	#Crimps
Tolerance						+ .010/- .010	+ .010/- .010	+/- .030	+/- .060	+/- .060	+/- .030	
410L	Flare	4	#10	Flared	Bare CU/Tin	0.410	0.286	0.475	1.370	0.660	0.545	1
414L	Flare	4	1/4	Flared	Bare CU/Tin	0.410	0.286	0.475	1.510	0.660	0.545	1
4516L	Flare	4	5/16	Flared	Bare CU/Tin	0.410	0.286	0.475	1.510	0.660	0.545	1
438L	Flare	4	3/8	Flared	Bare CU/Tin	0.410	0.286	0.475	1.510	0.660	0.570	1
412L	Flare	4	1/2	Flared	Bare CU/Tin	0.410	0.286	0.475	1.510	0.660	0.670	1
214L	Flare	2	1/4	Flared	Bare CU/Tin	0.472	0.336	0.525	1.690	0.690	0.650	1
2516L	Flare	2	5/16	Flared	Bare CU/Tin	0.472	0.336	0.525	1.690	0.690	0.650	1
238L	Flare	2	3/8	Flared	Bare CU/Tin	0.472	0.336	0.525	1.690	0.690	0.650	1
212L	Flare	2	1/2	Flared	Bare CU/Tin	0.472	0.336	0.525	1.690	0.690	0.750	1
25162L	Flare	2 wide pad	5/16	Flared	Bare CU/Tin	0.472	0.336	0.525	1.690	0.690	0.620	1
2382L	Flare	2 wide pad	3/8	Flared	Bare CU/Tin	0.472	0.336	0.525	1.690	0.690	0.620	1
114L	Flare	1	1/4	Flared	Bare CU/Tin	0.495	0.360	0.575	1.710	0.690	0.645	1
1516L	Flare	1	5/16	Flared	Bare CU/Tin	0.495	0.360	0.575	1.710	0.690	0.645	1
138L	Flare	1	3/8	Flared	Bare CU/Tin	0.495	0.360	0.575	1.710	0.690	0.675	1
112L	Flare	1	1/2	Flared	Bare CU/Tin	0.495	0.360	0.575	1.710	0.690	0.750	1

Product Options

- Part Numbers listed are Bare Copper. For Tinned Lug, add "TP" to end of part number.
- For Bent Tang Lugs, add "45" or "90" to end of part number (after TP, if tinned).
- For special tang widths, stud clearances, barrel lengths, or any option you don't see, contact the Plant.

Notes
